



USER MANUAL

re-STREAM C2A

THANK YOU

Thank you for purchasing re-STREAM C2A wireless CarPlay adapter. We hope you will enjoy it! This instruction manual will get you started and ready to use wireless CarPlay in your vehicle with factory fitted wired CarPlay function.

ABOUT YOUR RE-STREAM C2A

- 1 **USB-C socket - connecting to vehicle**
- 2 **USB socket - for optional wired CarPlay function**
- 3 **LED light**



WHAT YOUR RE-STREAM C2A DOES

Your re-STREAM C2A lets you connect wirelessly to your vehicles smartphone interface outlet and stream CarPlay over Wi-Fi without using the USB-cable.

Specifications

- Power input: 5V 1~2.1A
- Power output: DC 5V 0.8~2A
- Power consumption: 0.15W
- Resolution: Adaptive

Compatibility

- iPhone 6 or newer with iOS 10+
- Vehicle requirement: Factory fitted wired CarPlay function

Icon description



Switch between CarPlay and original interface



Language selector, press to switch between languages

INSTALLING RE-STREAM C2A

- Plug in re-STREAM C2A to vehicle's smartphone USB-outlet.

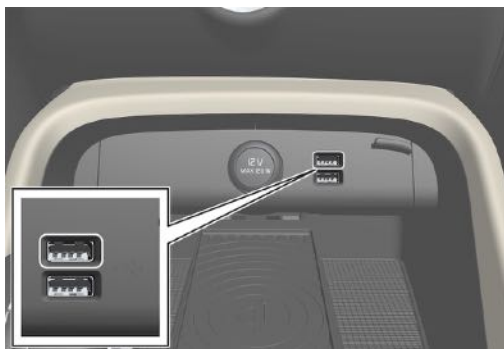

CONNECTING TO RE-STREAM C2A

- Search for new devices from car radio interface or iPhone.
- Confirm/accept the prompts in iPhone to use wireless CarPlay.

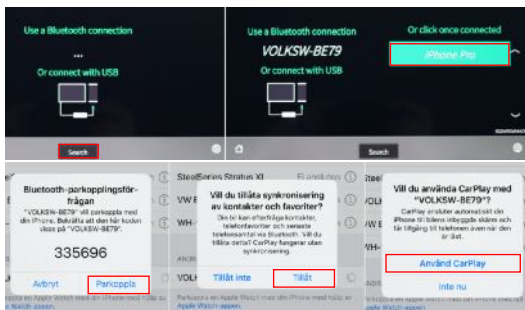

UPDATING RE-STREAM C2A

LED light/indicator	Status
Solid red light	In active mode
Solid red & blue light	Update successful

- Disconnect iPhone from C2A by disabling bluetooth on iPhone and restart C2A.
- Connect iPhone to C2A Wifi network with passcode 12345678.
- Scan the QR-code with iPhone camera or navigate to 192.168.50.2 and follow on-screen instructions.



TAKING CARE OF YOUR C2A

- Always store the re-STREAM C2A with power off and safely protected.
- Avoid storage at extreme temperatures (above 45°C – including direct sunlight – or below -10°C). This may affect operation.
- Do not expose re-STREAM C2A to rain or any other liquids.

Keep out of reach of children:

Plastic which the product and its parts are wrapped in are not toys for children. Small parts may cause choking if ingested. Never try to dismantle the product yourself. None of the internal components can be replaced or repaired by users.

Only Eftermontering i Karlstad AB may open the product. If any parts of your product require replacement for any reason, including normal wear and tear or breakage, contact dealer.

ACA TS028 – Ignition of flammable atmospheres

do not use products in environments where there is a danger of ignition of flammable gases.

WARRANTY

Limited one (1)-Year Warranty

Eftermontering i Karlstad AB, warrants this product to be free from defects in materials and workmanship (subject to the terms set forth below) for a period of one (1) year from the date of purchase ("Warranty period"). During the Warranty Period, Eftermontering i Karlstad AB will repair or replace (at Eftermontering i Karlstad AB's discretion) this product or any defective parts ("Warranty service"). If repair or replacement is not commercially practicable or cannot be timely made, Eftermontering Karlstad AB may choose to refund to you the purchase price paid for the affected product. Repair or replacement under the terms of this warranty does not give right to any extension or a new beginning of the period of warranty .

Claims under the warranty

To obtain Warranty Service, please contact the re-STREAM dealer from which you purchased this product or visit www.re-stream.se for further information about customer support. you will need to return this Product to the dealer or ship it to the dealer or to Eftermontering Karlstad AB (if so indicated on www.re-stream.se) in either its original packaging or packaging affording an equal degree of protection. You will bear the cost of shipping the product. If the Product is covered by the warranty, Eftermontering i Karlstad AB will bear the cost of shipping product back to you after the completion of service under this warranty. Return shipping will be charged to you for products not covered by the warranty or requiring no warranty repair.

the following information must be presented to obtain warranty Service: (a) the product, and (b) proof of purchase, which clearly indicates the name and address of the seller, date of purchase and the type of product, which is evidence that this product is within the warranty period. Please further include (c) your return address, (d) daytime telephone & email, and (e) reason for return. As part of Eftermontering i Karlstad AB's efforts to reduce environmental waste you understand that the product may consist of reconditioned equipment that contains used components, some of which have been reworked. The used components all live up to Eftermontering Karlstad AB's high quality standards and comply with the product performance and reliability specifications. You understand that replaced parts or components will become the property of Eftermontering i Karlstad AB.

Limitation of Warranty

This warranty is only valid for the original purchaser and will automatically terminate prior to expiration if this product is sold or otherwise transferred to another party. The warranty provided by Eftermontering i Karlstad AB in this statement applies only to products purchased for use, and not for resale. It does not apply to open box purchases, which are sold "as is" and without any warranty. Specifically exempt from warranty are limited-life consumable components subject to normal wear and tear.

This warranty is invalid if the factory-applied serial number, date code label, or product label has been altered or removed from this product. This warranty does not cover cosmetic damage or damage due to misuse, abuse, negligence, acts of nature, accident, disassembling or modification of, or to any part of, the product. This warranty does not cover damage due to improper operation, maintenance or installation, or attempted repair by anyone other than Eftermontering i Karlstad AB. Any unauthorized repairs will void this warranty.

Repairs or replacements as provided under this warranty are the exclusive remedy of the consumer. EFTERMONTERING I KARLSTAD AB SHALL NOT BE LIABLE FOR ANY INCIDENTAL OR CONSEQUENTIAL DAMAGES FOR BREACH OF ANY EXPRESS OR IMPLIED WARRANTY ON THIS PRODUCT. Except to the extent prohibited by law, this warranty is exclusive and in lieu of all other express and implied warranties what so ever, including but not limited to the warranty of merchantability and fitness for a practical purpose .

NOTE! This warranty gives you specific legal rights. You may have other rights which vary from location to location . some jurisdictions do not allow the exclusion or limitation of incidental or consequential damages or implied warranties, so the above exclusions may not apply to you. This warranty does not affect your legal (statutory) rights under your applicable national or local laws .

REGION

This device is intended to be used within the EU (Austria, Belgium, Bulgaria, Cyprus, Czech Republic, Denmark, Estonia, Finland, France, Germany, Greece, Hungary, Ireland, Italy, Latvia, Lithuania, Luxembourg, Malta, Poland, Portugal, Romania, Slovakia, Slovenia, Spain, Sweden, the Netherlands, United Kingdom, and within EFTA in Iceland, Norway and Switzerland).

© 2019 Eftermontering i Karlstad AB. All rights reserved. re-STREAM® is a registered trademark of Eftermontering i Karlstad AB. All other trademarks included herein are the property of their respective owners. The bluetooth® word mark and logos are owned by the bluetooth sIG, Inc.

www.re-stream.se

MADE IN CHINA



Dispose of the product according to local standards and regulations.